



## Technical data

Mechanical data	
Design	Profile, QR14
Dimensions	53.5 x 49 x 14 mm
Housing material	Plastic, PBT-GF30-V0
Electrical connection	Cable with connector, M12 × 1
Cable quality	Ø 5.2 mm, Gray, LifYY, PVC, 0.3 m
Core cross-section	4 x 0.34 mm <sup>2</sup>
Environmental conditions	
Ambient temperature	-25...+70 °C
Vibration resistance	55 Hz (1 mm)
Shock resistance	30 g (11 ms)
Protection class	IP68 IP69K
MTTF	138 years acc. to SN 29500 (Ed. 99) 40 °C
Power-on indication	LED, Green
Measuring range display	multifunction LED, green
Included in delivery	positioning element P1-Li-QR14/Q17L

## Mounting instructions

### Mounting instructions/Description

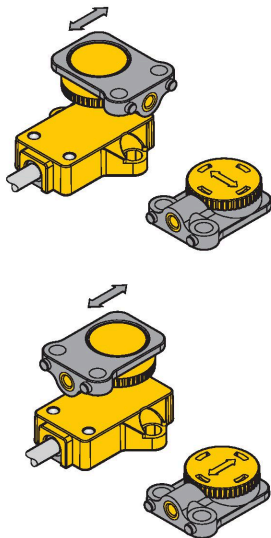

The positioning element can be mounted offset by 90°. This provides highest mounting flexibility.

The measuring principle of RLC coupling makes the sensor immune to magnetized metal splinters and other interference fields.

#### LED indications

green

positioning element is in the measuring range

green flashing:

positioning element is in the measuring range, the distance is too large. This is indicated by a weaker signal

off

positioning element is outside the coverage.

Accessories

P1-LI-QR14/Q17L 1590724

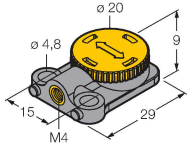

Floating positioning element for linear position sensors LI-QR14 and LI-Q17L; transverse and longitudinal mounting possible; the nominal distance to the sensor is 1.5 mm; pairing with the linear position sensor at a distance of up to 3 mm or a misalignment tolerance of up to 3 mm

Accessories

Dimension drawing	Type	ID	
	RKS4.4T-2/TXL	6626333	



Connection cable, M12 female connector, straight, 4-pin, shielding on coupling nut; cable length: 2 m, jacket material: PUR, black; cULus approval